

## Bookcase Hard-to-Find Hardware

The following supplies are available from *Woodworker's Journal*.

**Non-Mortise Hinges in Statuary Bronze (1) #28688 .... \$3.99 pr.**

**Antique Brass 1/4" Pin Supports (1) #22765 ..... \$4.59 (16-pk.)**

**Antique Brass 1/4" Pin Sleeves (1) #22856 ..... \$4.29 (16-pk.)**

**Magnetic Catch for Inset Doors (1) #30546 ..... \$5.59 ea.**

To purchase products online, visit [www.woodworkersjournal.com](http://www.woodworkersjournal.com) and click on the "Store" tab. Or call 800-610-0883 (code WJ1423).

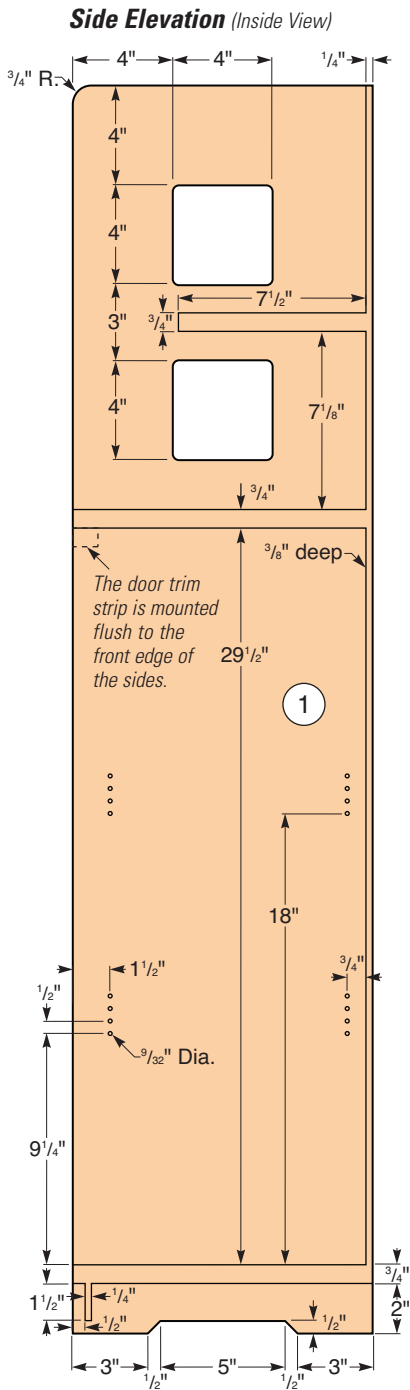

### Kick

(Top and front Views)

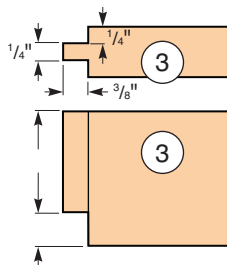

### MATERIAL LIST (CASE)

	T x W x L
1 Sides (2)	3/4" x 12" x 50"
2 Fixed Shelves (2)	3/4" x 12" x 29 1/4"
3 Kick (1)	3/4" x 2" x 29 1/4"
4 Gallery Shelf (1)	3/4" x 7 3/4" x 29 1/4"
5 Back Panel (1)	1/4" x 29 1/4" x 38 1/2"
6 Gallery Back (1)	3/4" x 9 1/2" x 29 1/4"
7 Adjustable Shelves (2)	3/4" x 10 1/4" x 28 1/2"
8 Door Trim Strip (1)	3/4" x 1" x 28 1/2"

**Door Frame**  
(Front View)

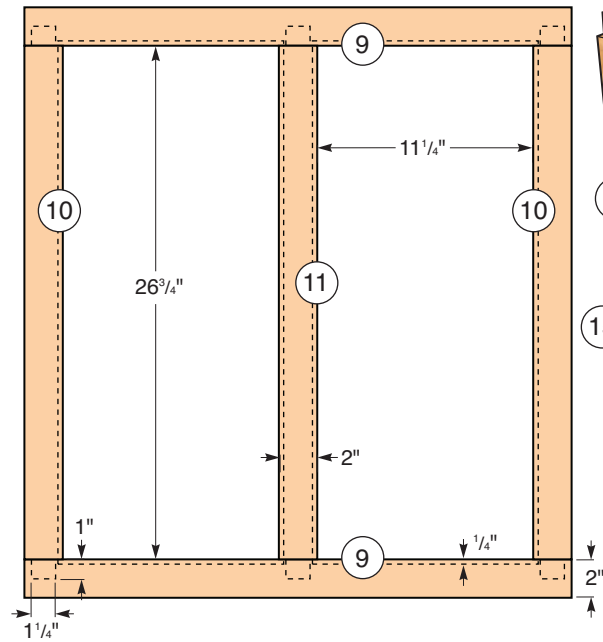

**Door Exploded View**

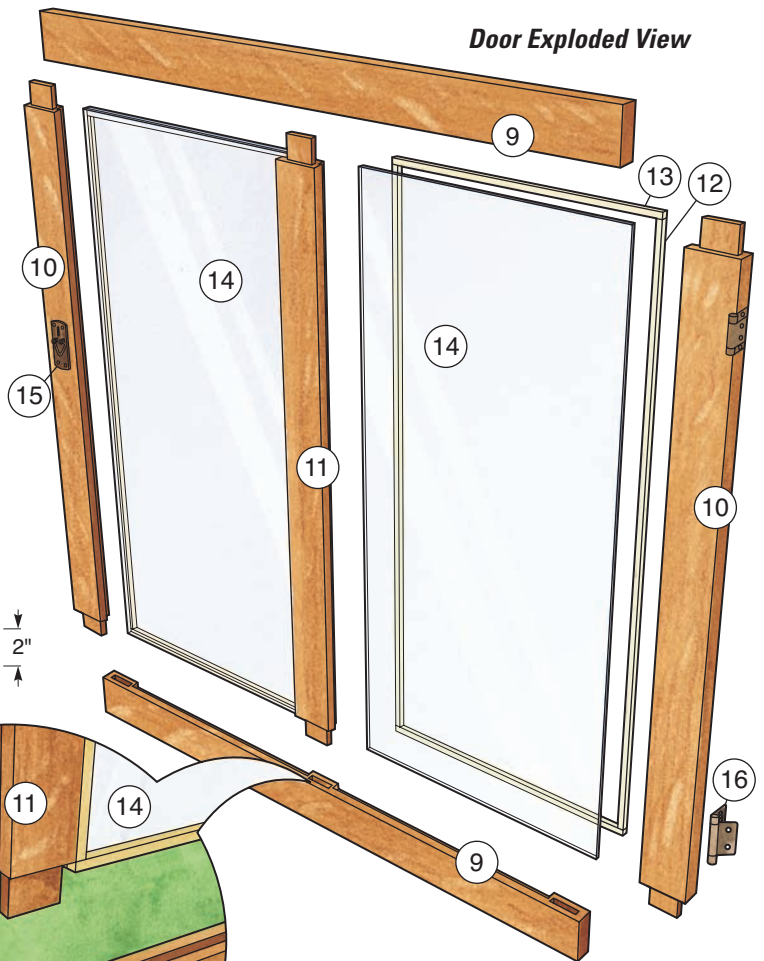

**Outer Door Stile**  
(End and Inside Views)

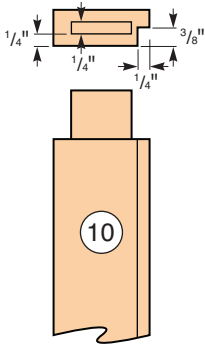

**Center Stile Assembly**

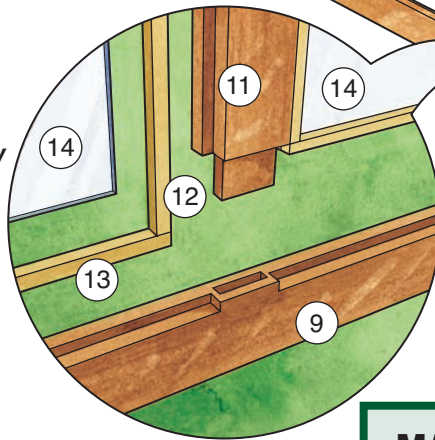

**MATERIAL LIST (DOOR)**

	<b>T x W x L</b>
<b>9</b> Door Rails (2)	3/4" x 2" x 28 1/2"
<b>10</b> Outer Door Stiles (2)	3/4" x 2" x 26 3/4"
<b>11</b> Middle Door Stile (1)	3/4" x 2" x 26 3/4"
<b>12</b> Long Retaining Strips (4)	1/4" x 1/4" x 24 3/4"
<b>13</b> Short Retaining Strips (4)	1/4" x 1/4" x 11 3/4"
<b>14</b> Glass Panels (2)	1/8" x 11 3/4" x 25 1/4"
<b>15</b> Door Pull (1)	Craftsman V-pull
<b>16</b> Hinges (2)	No-mortise
<b>17</b> Door Catch (1)	Magnetic